



# How to measure your kitchen

A step-by-step guide

# Step 1

## Measure & draw your space

- Grab your measuring tape, paper, and a pencil
- Draw a birds-eye diagram of your room including doors & windows, and anything that sticks out like boilers
- Start in one corner and measure each element of the room, working clockwise so you don't miss anything
- Label your drawing with all your measurements
- Measure the height of your room, including the distance from the floor to the bottom of your windows

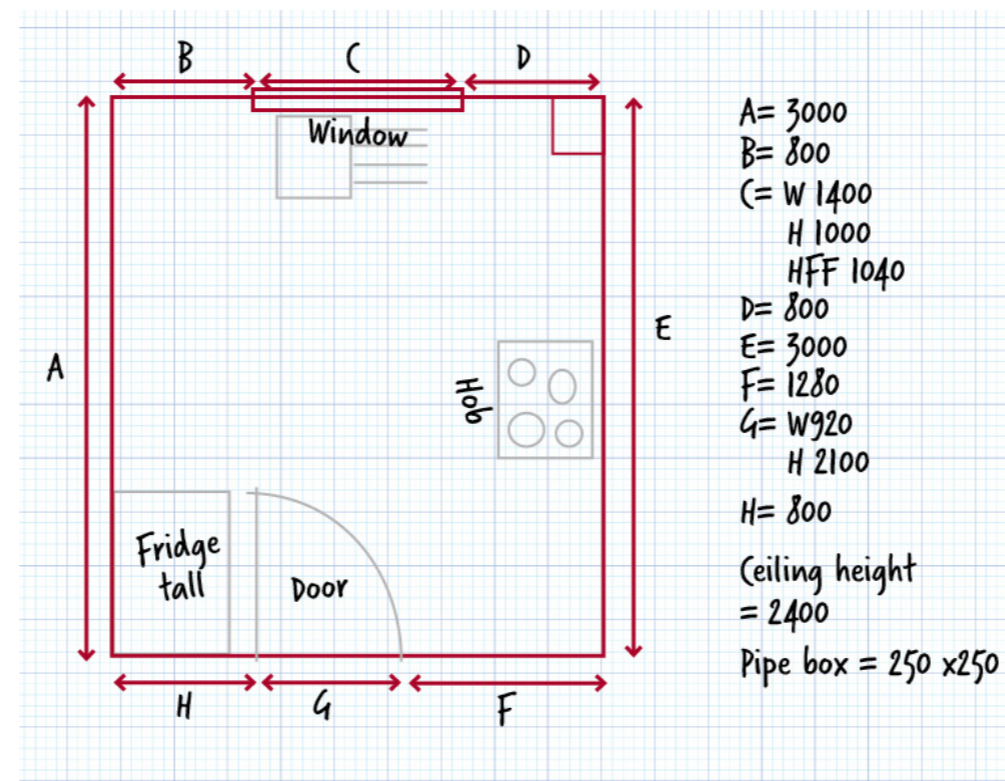

### Top tip

Make sure all your measurements are in mm & measure twice!

# Step 1

Use our handy checklist below to make sure you've covered the basics:

- ✓ Walls
- ✓ Doors & windows
- ✓ Ceiling height
- ✓ Boilers
- ✓ Radiators
- ✓ Plug sockets
- ✓ Water supply
- ✓ Gas supply
- ✓ Pipes
- ✓ Appliances

Take pictures of your space too as a reference tool, as well as for pleasing before-and-after posts!

### Top tip

*Don't forget to include frames when measuring doors & windows!*

Step  
2

# Consider your layout

Your kitchen is the centre of your home, so making the most of your space is crucial to making your home life that little bit easier.

Every kitchen is different, so start by choosing the layout which is closest to your requirements.



### Linear

A straightforward setup for compact kitchens

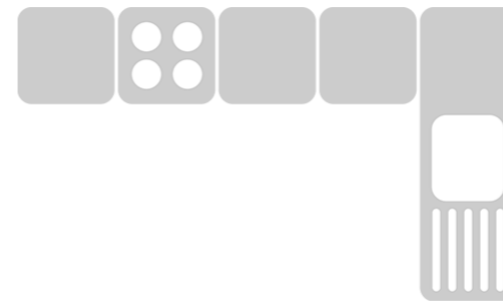

### L-Shape

Give yourself space to move around, or pop in a table

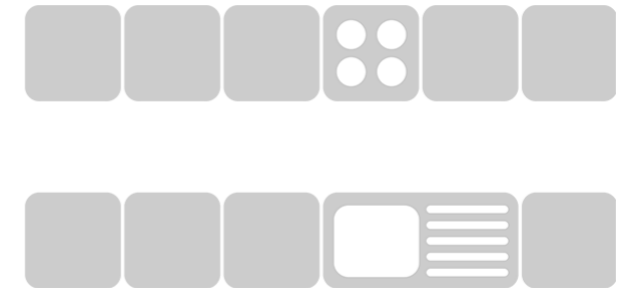

### Galley

Keep everything close by in long, narrow kitchens

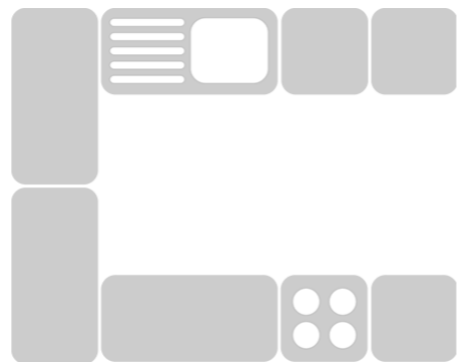

### U-Shape

Maximise your space and enjoy freedom of movement

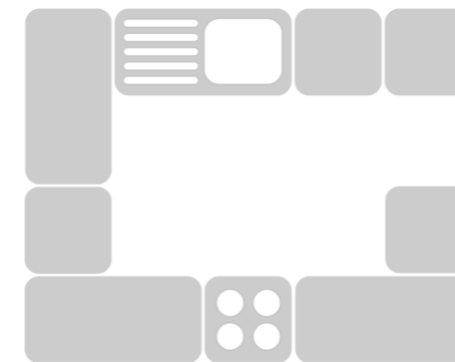

### G-Shape

Gives you plenty of storage and worktop space for a social feel

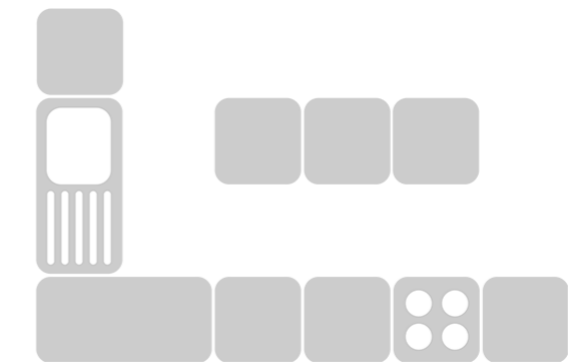

### Island

Ideal for open plan entertaining and larger kitchens

Step  
3

# Plan your kitchen triangle

Your kitchen triangle is the space between the 3 most important areas of your kitchen:

● Sink    ● Hob & oven    ● Fridge

Ideally, you want these 3 zones equally distanced so you can navigate your kitchen efficiently like a pro! Your sink is the most-used area of your kitchen, so make sure that it's easy to get to.

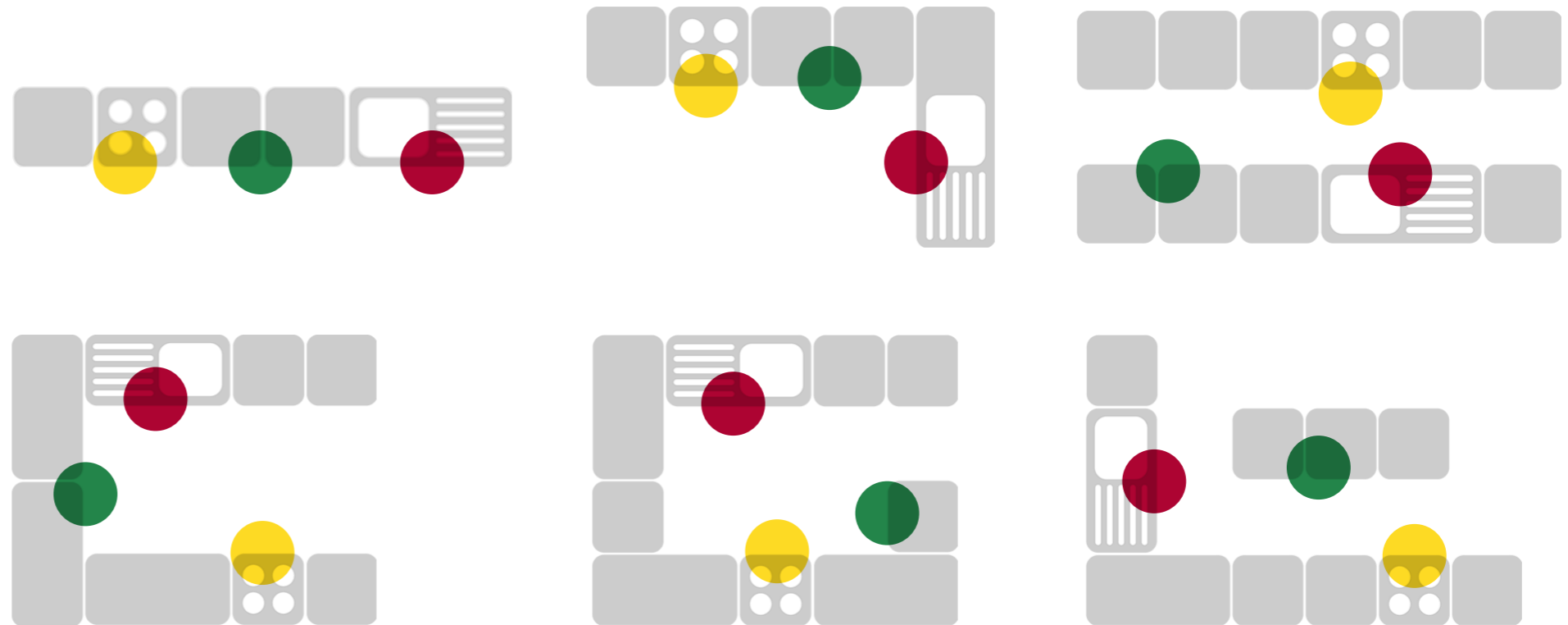

### Top tip

Don't put large appliances directly opposite each other – all doors should open freely!

Step  
4

# Start designing your perfect kitchen!

Now for the exciting bit: putting together your perfect kitchen!

In our kitchen units page, you'll find 6 distinct styles of wilko kitchens to choose from. Whether you're into classic Shaker kitchens or after a modern twist with Slab & J Pull designs, there's plenty of choice when it comes to design & colour.

Once you've chosen your design, piece together your kitchen from our range of high-quality units including cabinets, drawers, appliance units & tall kitchen cabinets.

